

ROCKARMOR

Fitting Instructions

Description:	Toyota Hilux N80 Rock Sliders/Side Steps (2015-Current)
Model:	Toyota Hilux N80
SKU:	SSSRA-HILN80



Important Notice – Please Read Before Installation

Before commencing the installation, please ensure you have **carefully read and understood all instructions**. Rockarmor products are engineered to the highest standards using premium materials and finishes. This includes **sandblasting all raw materials, e-coating to eliminate impurities**, and applying a **Tiger powder coat** for enhanced durability.

Should the product become scratched or damaged during off-road or on-road use, the affected surface must be **repaired promptly** to maintain corrosion resistance and product longevity.

Installation must be carried out by a qualified technician, and all steps must be followed precisely to ensure a secure and proper fit.

Side Impact Airbag Compatibility

If your vehicle is equipped with **side impact airbags**, the Rockarmor side steps have **airbag-compatible brackets** integrated into the design. These brackets allow the side steps to remain compliant with airbag deployment safety standards while still offering robust protection and functionality.

While Rockarmor side steps are engineered to be durable and suitable for off-road use, **we strongly advise against using them as a high-lift jack point**. Applying a high lifting force may compromise the structural integrity of the **airbag support brackets**, and could impact airbag performance in the event of a collision.

Note: Please Read Before Attempting Installation

- This product and its fixings **must not be modified** unless explicitly stated in these instructions.
- **Do not remove** any product labels or compliance markings.
- This product is intended solely for use on the **specified vehicle model** outlined in this guide.
- The installer must ensure adequate **clearance between the chassis and body**, and proper fitment to all mounting points.
- **Loctite must be applied** to all bolts and nuts during installation.
- Specialized tools may be required, and we strongly recommend installation be carried out by an **experienced 4x4 accessory fitter**.

Liability Waiver

By proceeding with the installation, the installer acknowledges responsibility for adhering to these instructions.

Rockarmor Pty Ltd accepts no liability for any damage, injury, or vehicle malfunction arising from:

- Improper installation
- Use of this product in a way not intended or advised
- Failure to follow the provided fitting guide

Any deviation from the instructions or product modification will **void all warranties** and transfer all associated risks and liabilities to the installer and/or vehicle owner.

Occupational Health and Safety (OHS) Guidelines for the Workshop

Hearing Protection

All personnel must wear appropriate hearing protection in high-noise areas or when operating loud machinery to prevent hearing damage.



Eye Protection

Approved safety glasses or goggles must be worn at all times to shield the eyes from debris, chemicals, and other hazardous materials.



Safe Manual Handling Procedures

Use correct lifting techniques to avoid strains and injuries. Where possible, utilize mechanical aids and never exceed personal lifting capacity.



Hazard Awareness and Prevention

Remain vigilant of potential hazards within the workshop. Adhere to all posted warning signs and follow established safety protocols to mitigate risks.

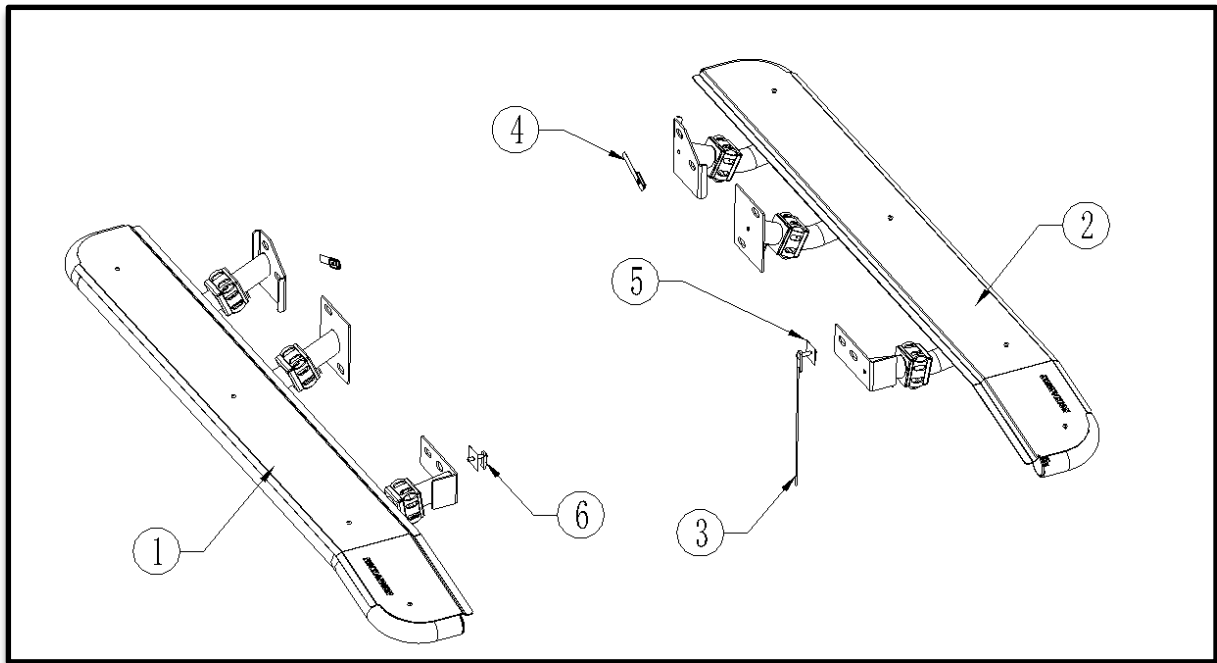

**Please Note:**

- 1) These Side Steps/ Rock Sliders cannot be installed onto other vehicles, in addition to the manufacturer special instructions
- 2) Do not remove labels on the Products.
- 3) Do not change the structure of Side Steps/ Rock Sliders.

Standard locking torque

M6 - 11Nm | M8 - 18Nm | M10 - 80 Nm | M12 - 90 Nm | M16 - 90 Nm

Installation Steps:**Remove the Original Plastic Sidestep**

Fitting Instructions – Rockarmor Rock Sliders for Hilux N80

Preparation & Overview

- Lay out all components and hardware from your kit.
- Inspect the Rockarmor side steps:
- Checker plate top for grip.
- Rear folded lip to protect the sill from dirt and damage.
- Foam strip pre-fitted between the top plate and tubing to reduce vibrations.



Key Features

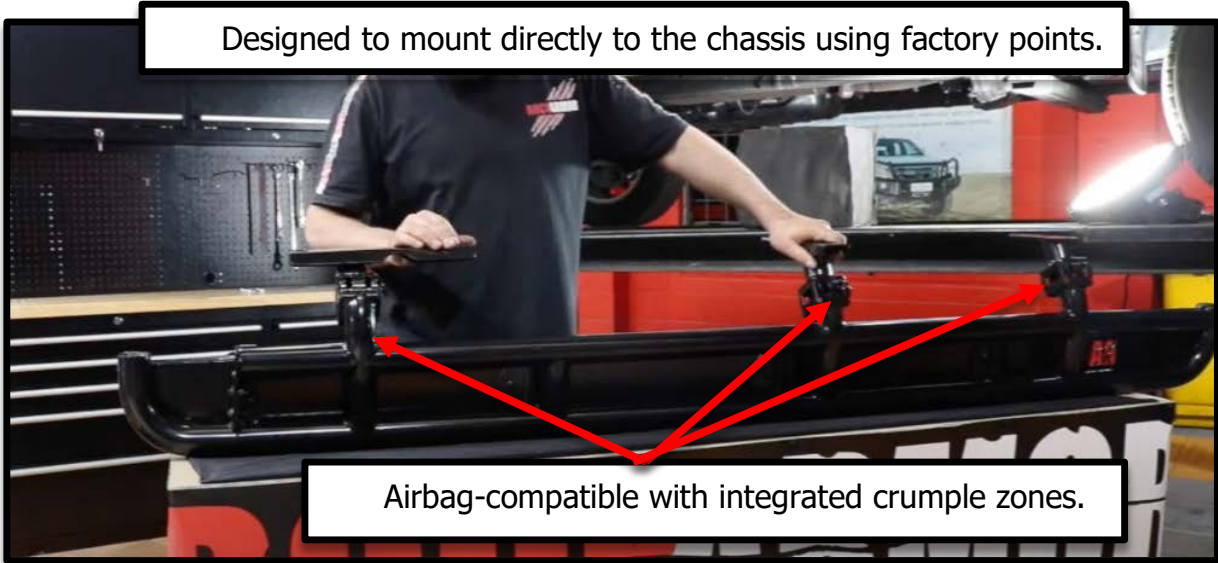
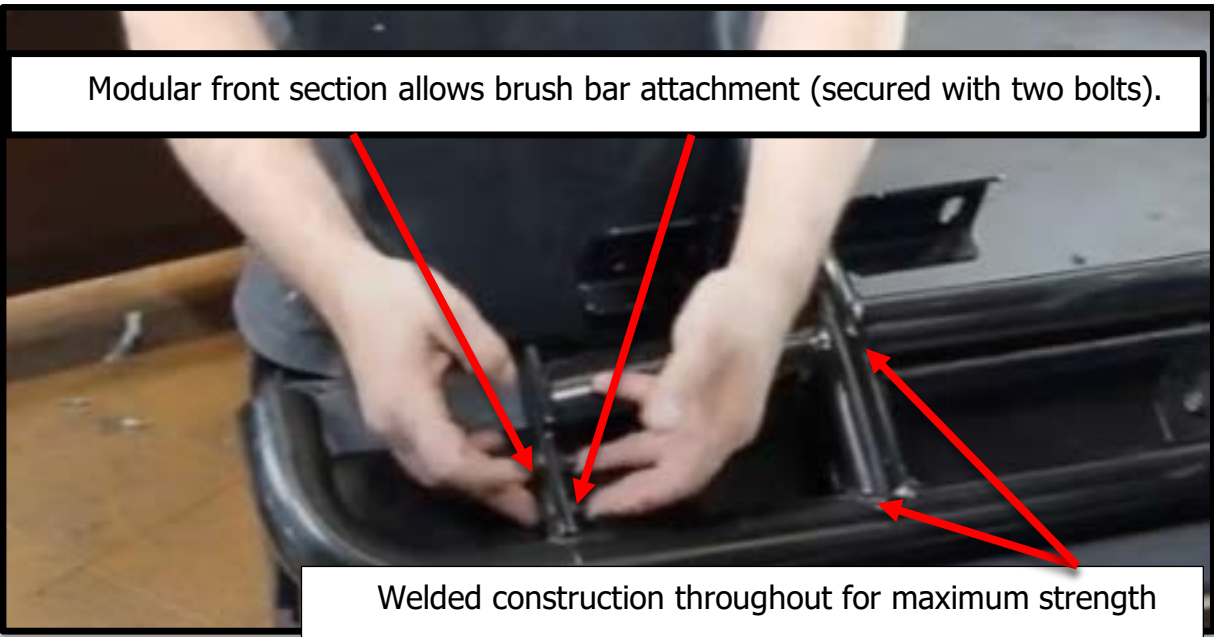
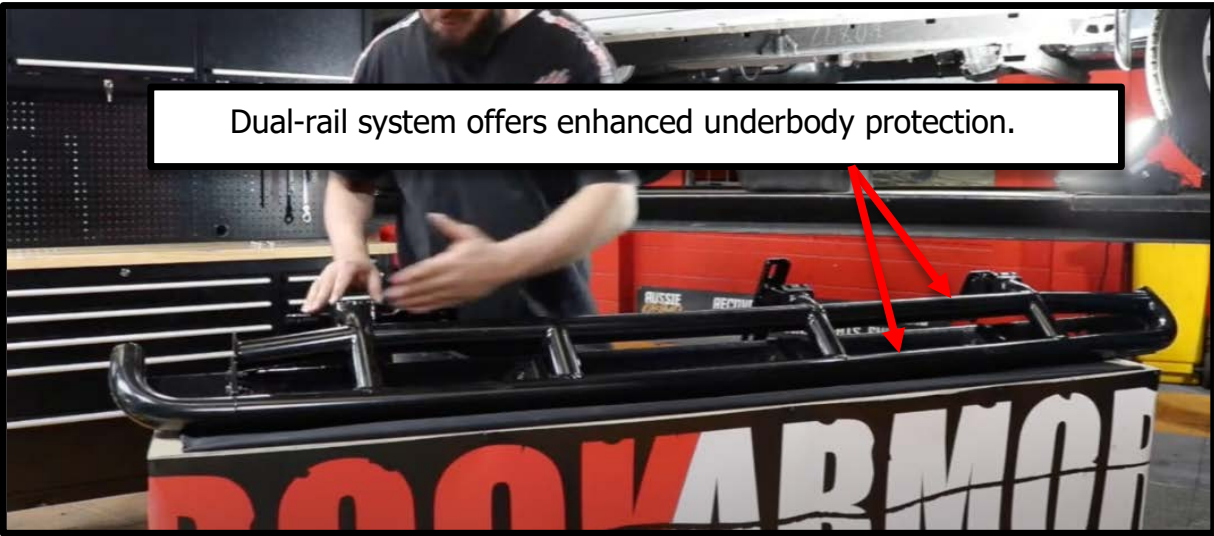



Identify Mounting Locations

The N80 Hilux has **three main mounting points per side:**

Front Mount

- Long bolt through chassis
- Secured with flat + spring nut

Secondary Front Mount

- Uses **insert plate (nut plate)** inside chassis

Centre Mount

- Uses **U-bolt around chassis**

Rear Mount

- Driver side: long bolt through chassis
- Passenger side: nut plate (due to fuel tank)

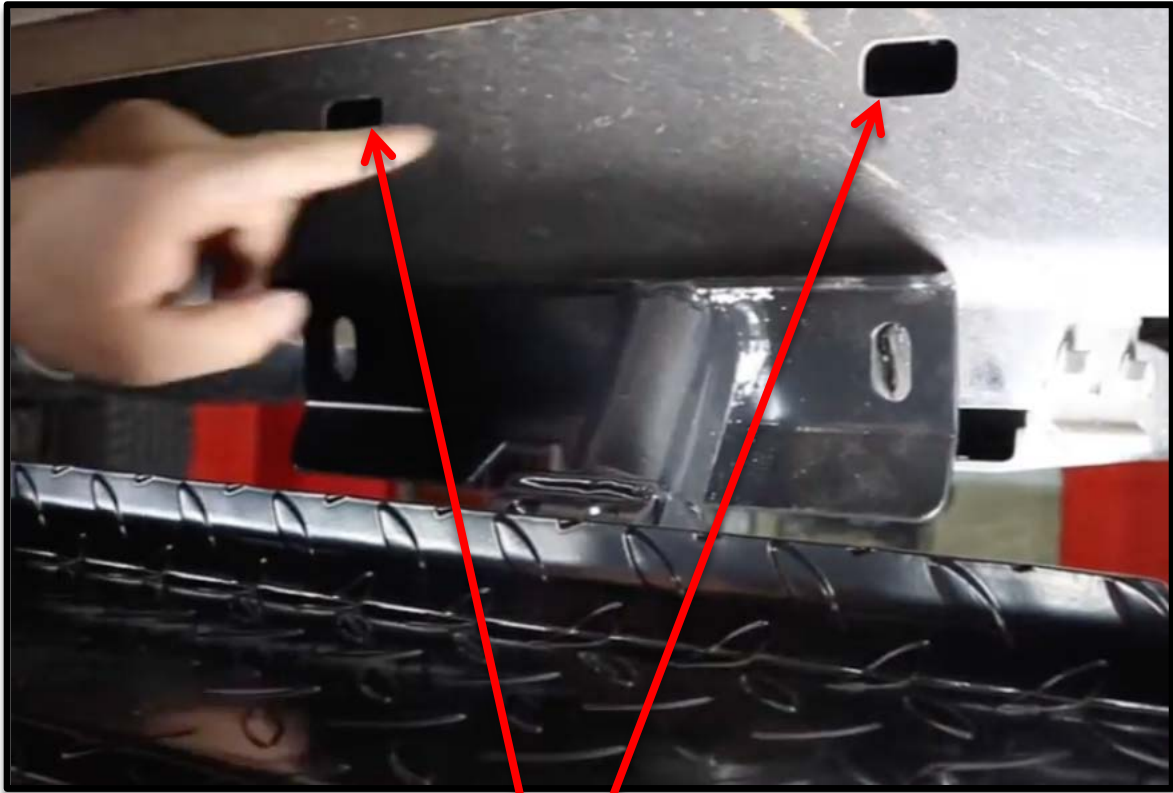

Identify Front Mount



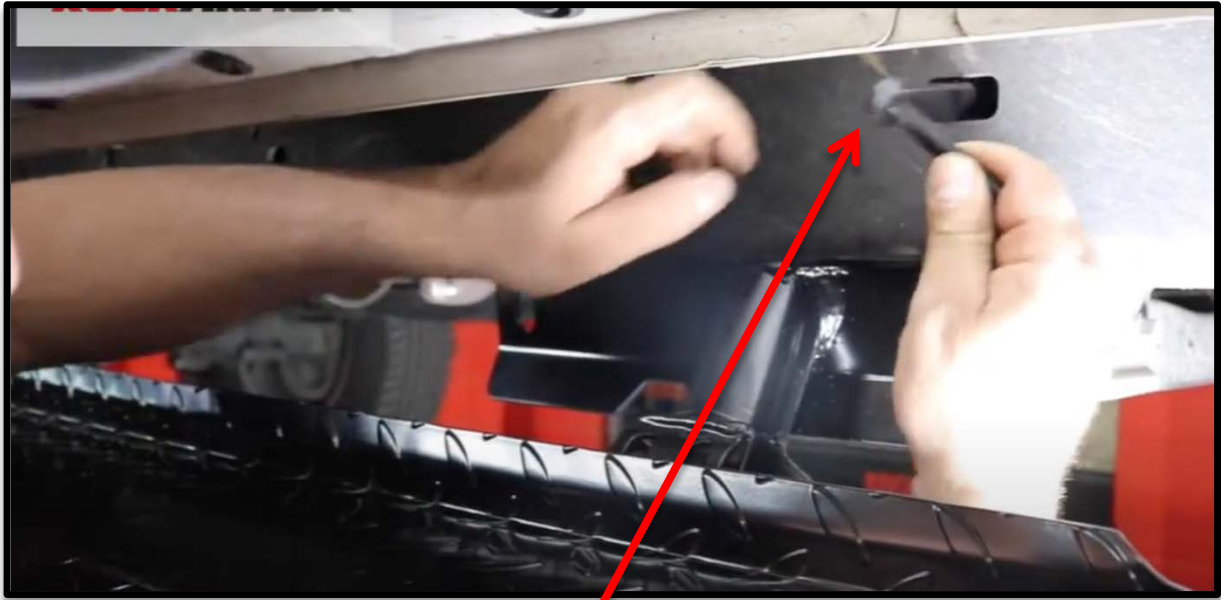

Install Front Plate Insert

- Insert nut plate into chassis opening
- Align with mounting hole
- Optional: secure temporarily with cable tie



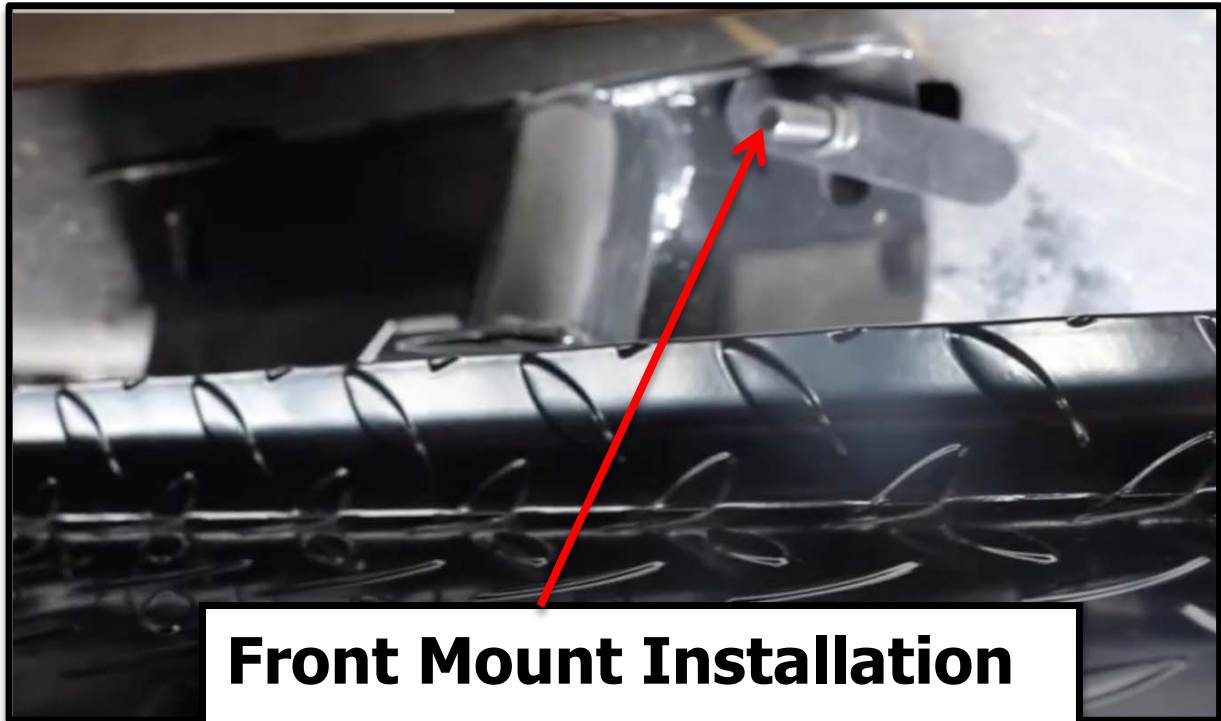

Front Mount Installation

Install:

- Spring washer
- Nut

⚠ Leave hand tight





Rear Mount Installation (Driver Side)

Install Rear Bolt (Driver Side)

1. Insert bolt with washer through chassis
2. Secure from opposite side using:
 - Flat washer
 - Spring washer
 - Nut





Centre Mount Installation

1. Wrap U-bolt around chassis
2. Align with side step bracket
3. Install:
 - Flat washer
 - Spring washer
 - Nut



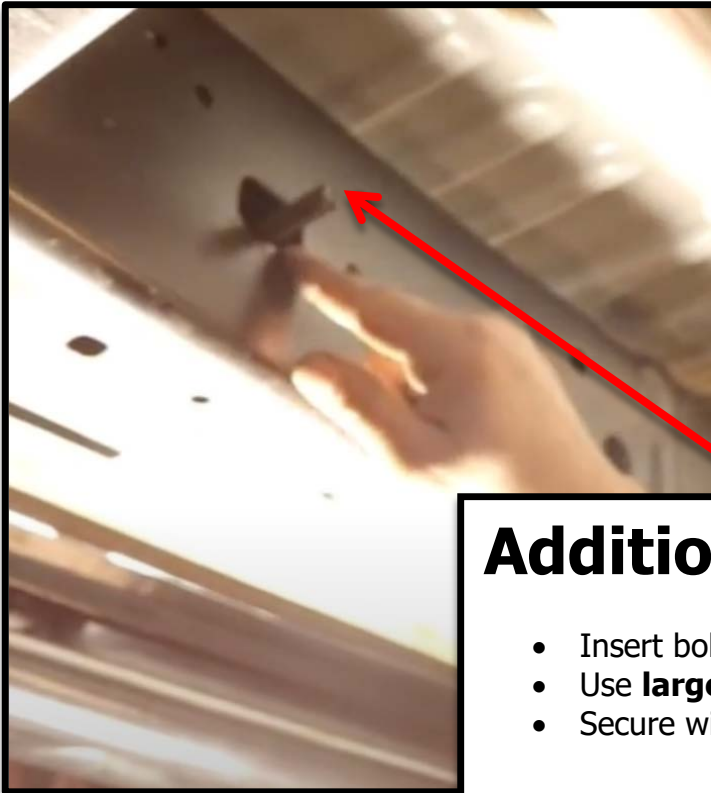

Additional Front Mount

- Insert bolt through chassis
- Use **large washer** (for oversized chassis hole)
- Secure with nut

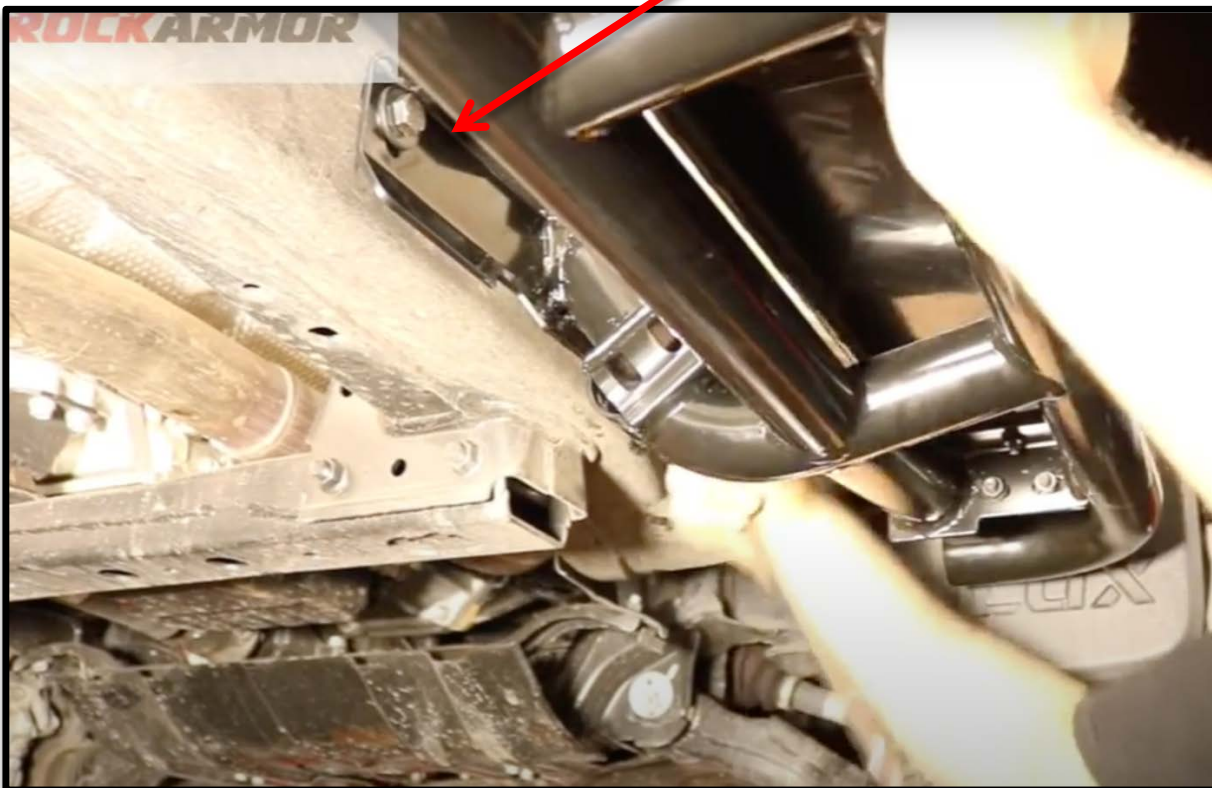

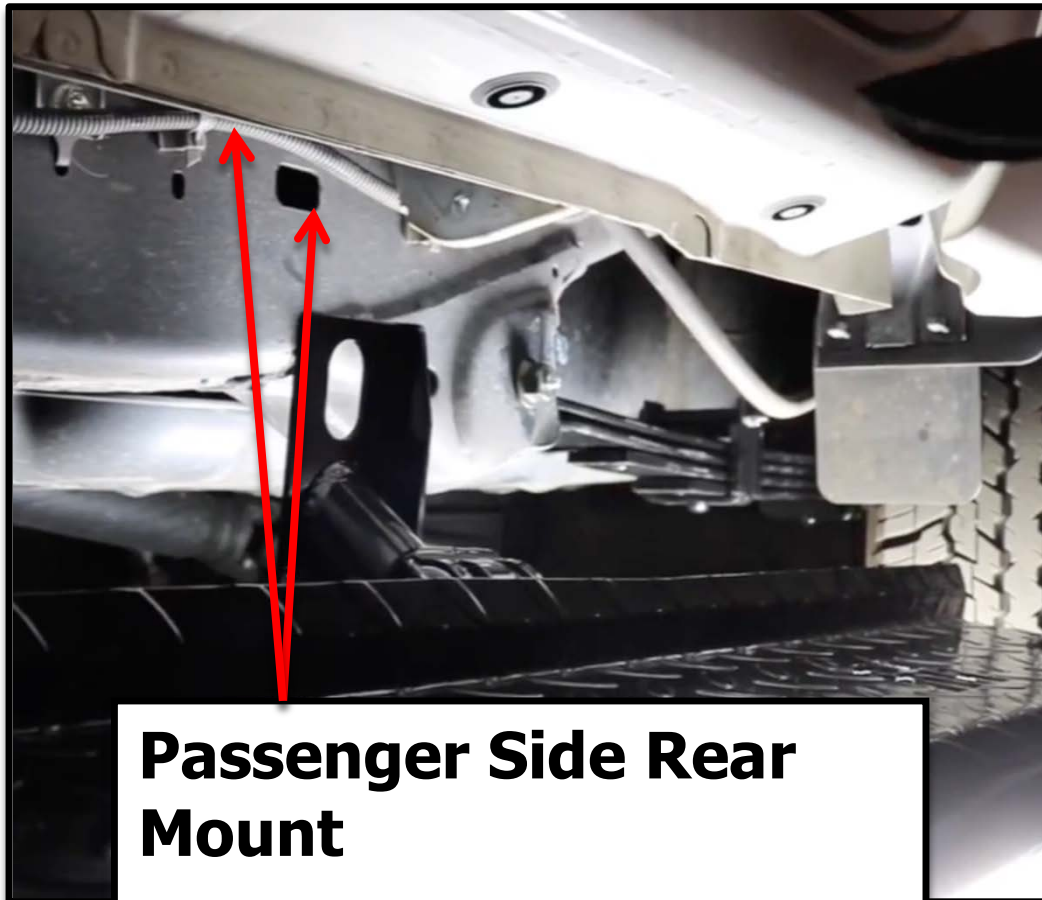

Passenger Side Rear Mount

- Insert bolt through chassis
- Use **large washer** (for oversized chassis hole)
- Secure with nut
- Move cable out of the way before fitting

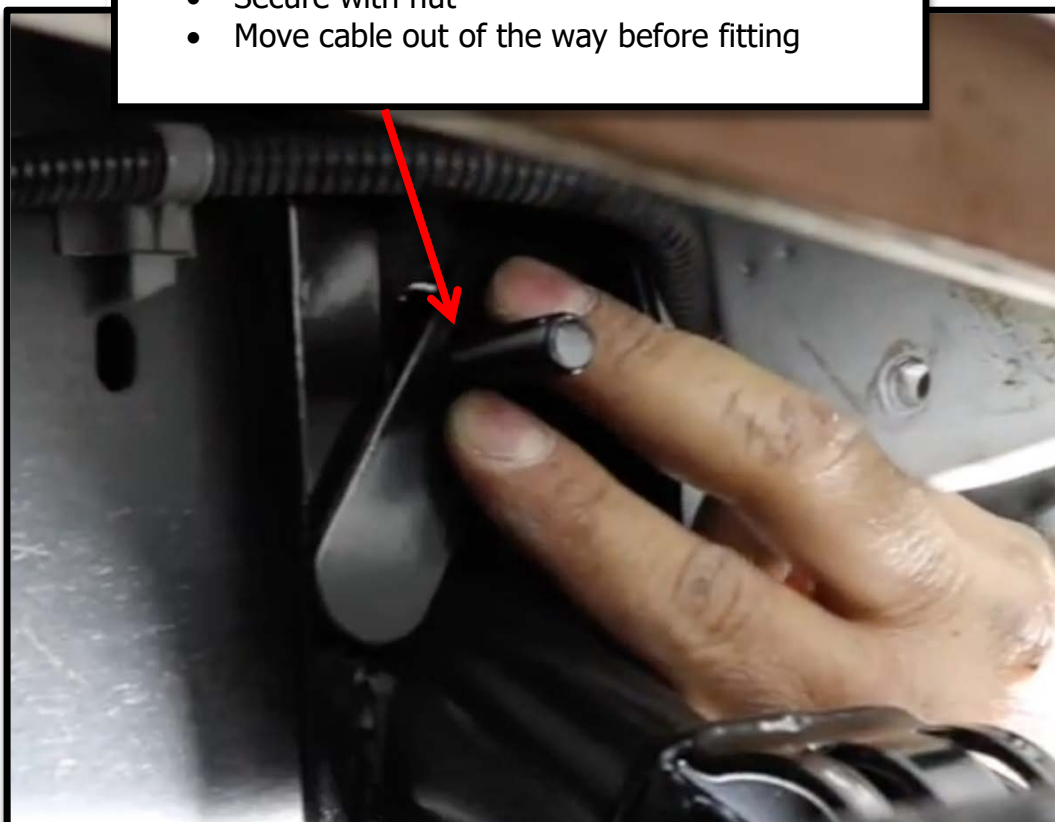



Align & Tighten



Final Assembly and Testing

- Description: Tighten all bolts to the specified torque values. Inspect the installation for stability and ensure all components are securely fastened. Test fit the guard to confirm there are no vibrations or misalignments. Check regularly as bolts/nuts may loosen over time.
- Safety Note: Do not operate the vehicle without completing the final inspection.

Disclaimer

Rockarmor Pty Ltd accepts no liability for damages, injuries, or vehicle malfunctions arising from improper installation or failure to follow the fitting instructions provided.

We strongly recommend that this product be installed by a qualified and experienced fitter using the correct tools and procedures to ensure both safety and optimal performance.

Any modification of the product or deviation from the outlined installation process will void all warranties and transfer full responsibility to the installer and/or vehicle owner.

By proceeding with the installation, the installer acknowledges and accepts all associated risks and responsibilities.

Maintenance Note – Side Steps

To maintain the longevity of your side steps, promptly touch up any scratches with rust-proof paint or a suitable protective coating.

Do not use a high-lift jack on the airbag-compatible rock sliders, as this may interfere with the side impact airbag bracket.

If brush bars are not installed, ensure the front-end cap is securely fitted to protect against wear and environmental exposure.